

INFORMATION FROM SITE SURVEY	
1. OCCUPANCY	= G1 - OFFICE
2. FLOOR AREA	= 657 m²
3. EXISTING SIGNAGE EQUIPMENT AS INSTALLED ON SITE:	
4.1. FIRE EXTINGUISHERS	= 6
4.2. FIRE HOSE REEL	= 1

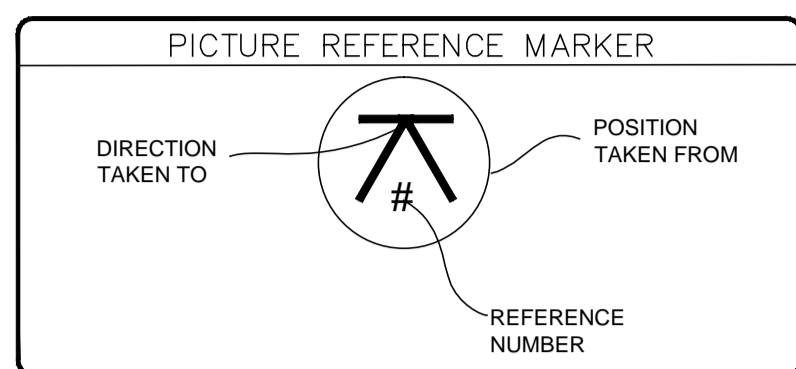

- MAJOR LIST OF NON- CONFORMANCES
1. NO FIRE HYDRANT TO TWO STOREY STRUCTURE.
 2. PARTITION LAYOUT DOES NOT MATCH DRAWINGS.
 3. ESCAPE DOORS DOES NOT OPEN IN DIRECTION OF TRAVEL.
 4. TURN STYLE TO RELEASE IN FIRE CONDITION.
 5. NO BREAK GLASS UNIT LOCATION SIGNS.

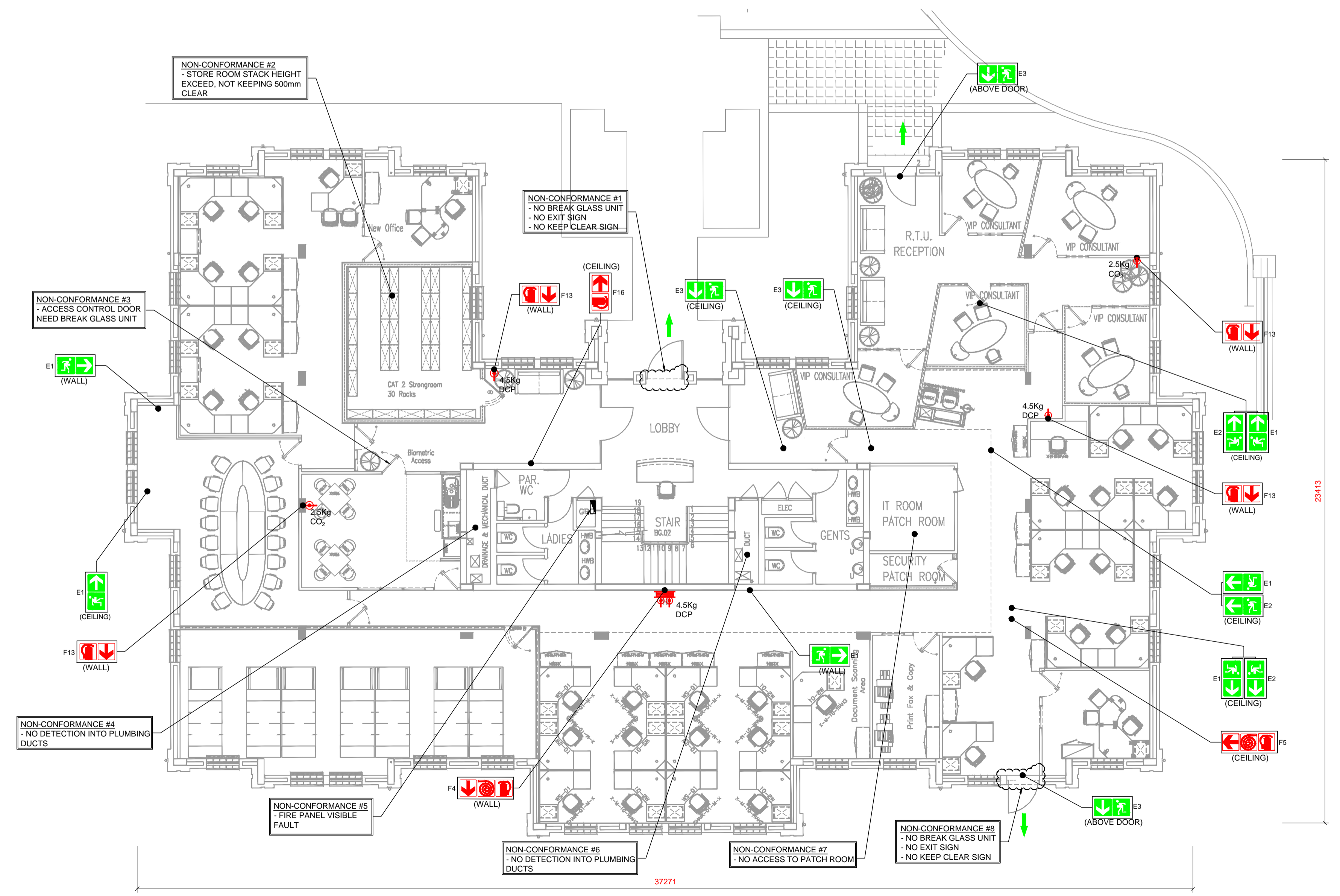

ISSUE DATE:	2021-05-25	REVISION:	A
X	FOR INFORMATION		
	FOR APPROVAL		
	FOR TENDER		
	FOR CONSTRUCTION		
	AS-BUILT		

REVISIONS				
No	Date	Description	Rev By	Ckd By
A	25/05/2021	ISSUED FOR INFORMATION	S.M	H.R

09 Plantanus Street
Kuilsriver
7580

Cell.: (072) 948 4470
Tel.: (021) 903 1407
Email: info@consultmech.co.za

PROJECT: LAHAE LA SARS - BLOCK B

DWG TITLE: BROOKLYN

DWG TITLE: GROUND STOREY - EXISTING

DWG TITLE: FIRE SERVICES LAYOUT

DWG NUMBER: 21B09-F-502-01 REV: A

DESIGNED BY: M. MAJEKE SCALE: 1:100 @ A1

CHECKED BY: H.D ROUX ECSA NUMBER: 201070151

APPROVED BY: H.D ROUX ECSA NUMBER: 201070151

COPYRIGHT AND RIGHT OF REPRODUCTION OF THIS DRAWING OR ANY PORTION THEREOF IS RESERVED BY THE ENGINEERS

GROUND STOREY - EXISTING FIRE SERVICES LAYOUT (Scale 1:100)